



HAS1PTD

PT Driver for Bi-Spectrum Bullet VGA
The PT Driver is compatible with the following Honeywell camera

- HCS1TB4R1VT09
- HCS1TB4R4VT15
- HCS1TB4R2VT25
- HCS1TB4R2VT35
- HCS1TB4R2VT50
- HC60TB4R1VT09
- HC60TB4R4VT15
- HC60TB4R2VT25
- HC60TB4R2VT35
- HC60TB4R2VT50



The following accessories are provided along with the package:

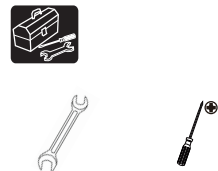
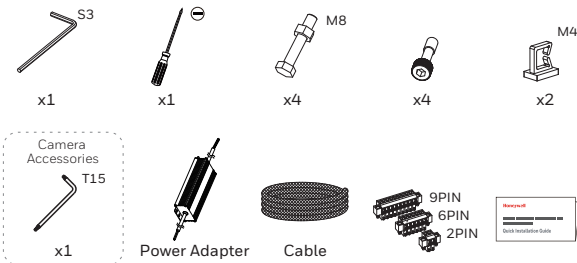

Specfications

PARAMETER	
Material	ADC12
Color	RAL 9003 (Signal White)
Dimensions	210.4×210 ×498.8mm (8.28″×8.27″×19.64″)
Product Weight	11.2 kg (24.7 lb)
Package Weight	18.5 kg (40.8 lb)

Installation Notes

- The surface must be capable of supporting at least three times (3×) the total weight of the camera and the mount.

Installation Instruction

1

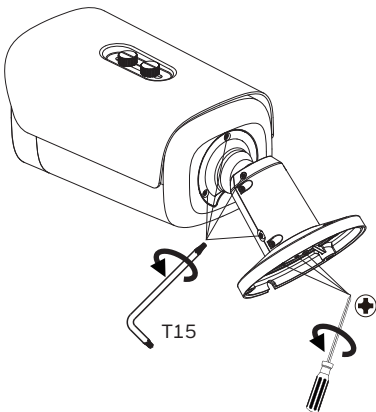

2

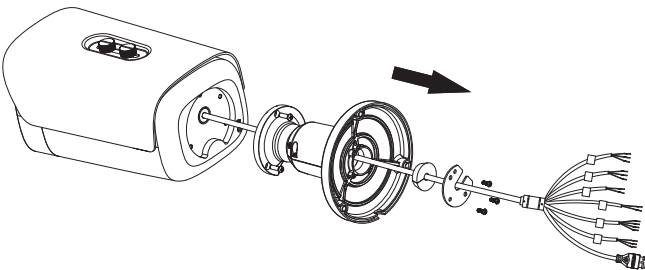

3

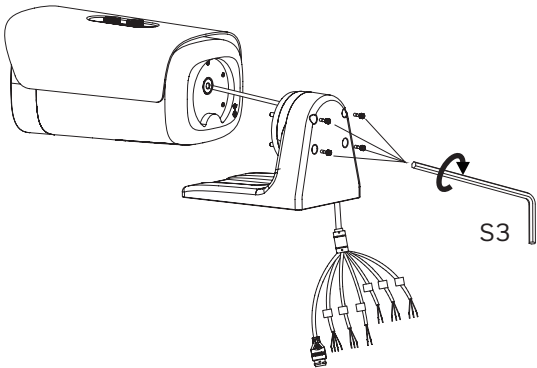

4

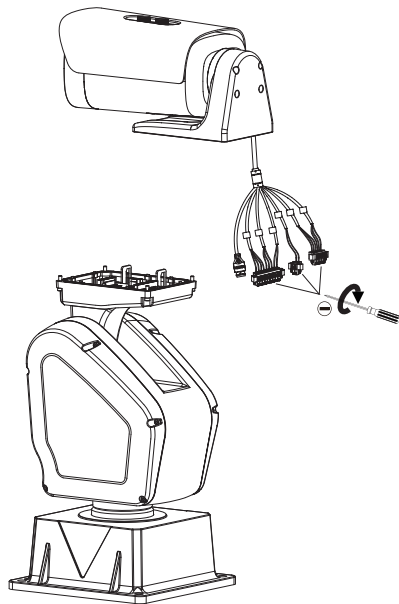

	Network		RJ45
	Alarm In		
	Alarm In	Blue	Alarm In1
		Brown	Alarm In2
		White	Alarm In Com
	Alarm Out	Pink	Alarm Out 1
		Purple	Alarm Out 1 com
		Orange	Alarm Out 2
		Grey	Alarm Out 2 com
	CVBS	Green Purple	CVBS
		Blue Purple	CVBS GND
	Power	Red	DC 12V +
		Black	DC 12V -
	Audio	White	Audio In
		Yellow	Audio Out
		Grey Black	Audio GND
	RS232	Blue	RS232 RX
		Green	RS232 TX
		Pink Black	RS232 GND

5

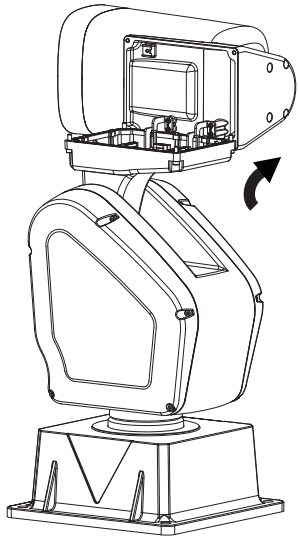

6

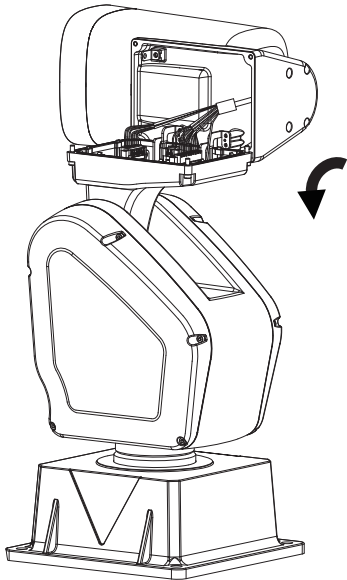

7

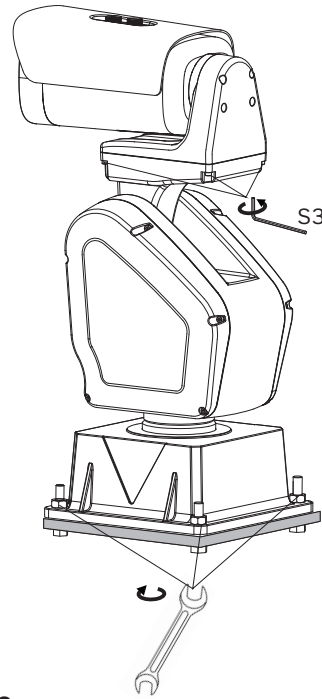

Dimensions

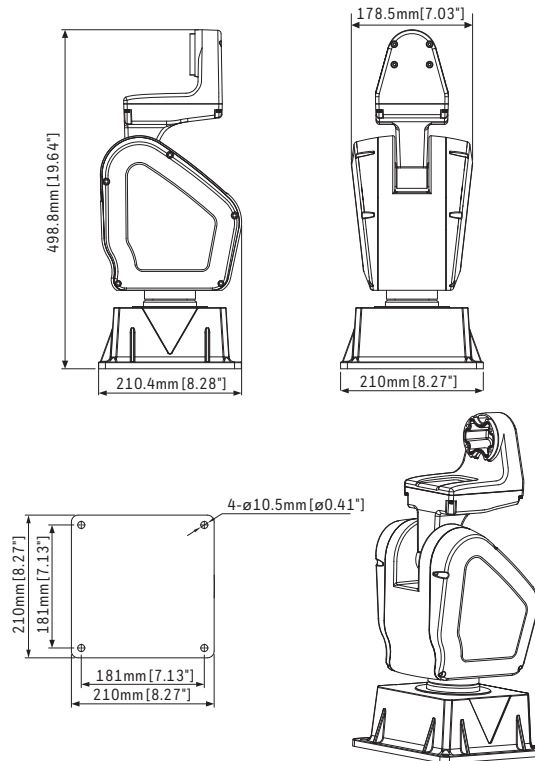

Honeywell

buildings.honeywell.com/security
+44 (0)1163 500714 (United Kingdom only)
Document 800-60IS18-Rev A-11/2024

© 2024 Honeywell International Inc. All rights reserved. No part of this publication may be reproduced by any means without written permission from Honeywell Video Systems. The information in this publication is believed to be accurate in all respects. However, Honeywell Video Systems cannot assume responsibility for any consequences resulting from the use thereof. The information contained herein is subject to change without notice. Revisions or new editions to this publication may be issued to incorporate such changes.